



THE **sage** PROJECT

Community Engagement for Sustainable Cities

2016-17 Partnership with Lemon Grove



SAN DIEGO STATE
UNIVERSITY

The Sage Project Model

- Connect existing faculty teaching existing courses with existing projects to real-world projects that address social, economic, and environmental goals for the Lemon Grove community
- Students engage in meaningful, real-world projects
- City gets creative ideas, designs, solutions, and resources that create momentum for moving projects forward

ENGAGEMENT: 5 CITIES, 4 YEARS



3200+
STUDENTS

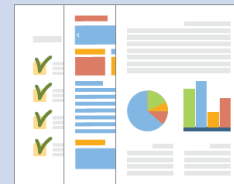

37 PROJECTS

28
DISCIPLINES



48 FACULTY
MEMBERS



104
COURSES

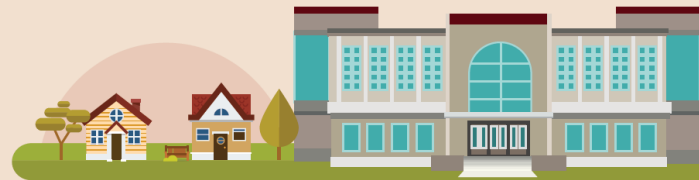

100,000s of HOURS
OF EFFORT TOWARDS LOCAL COMMUNITIES



SAN DIEGO STATE
UNIVERSITY



Projects with Lemon Grove

Mapping City Assets and Infrastructure

Crystal English, Geography

Atsushi Nara, Geography

Isaac Ullah, Anthropology

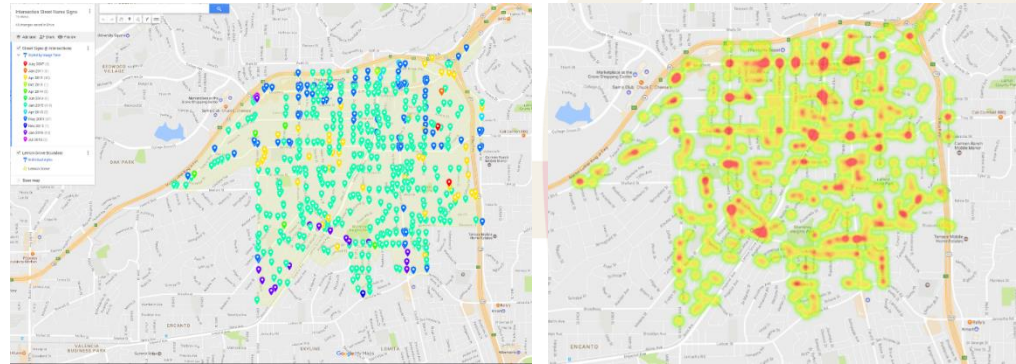

Includes 584 street sign points, 157 stop sign points, and 20,480 tree points collected

Infrastructure Maintenance

Lester Parking Structure

John Prince and James Haughey, Civil Engineering

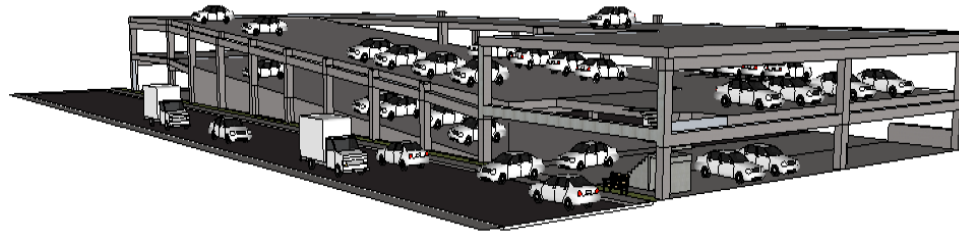

Place-Making and Tactical Urbanism

Urban Design and (Re-)Development

Bruce Appleyard, City Planning

Dana Kuhn and Seth Kaplowitz, Real Estate & Finance



Homelessness

Policy and Outreach

Kristen Maher, Political Science

Kurt Lindemann, Communication

Shelley Orr, Theater

Shawn Flanigan, Public Administration



Public Art

Art Walls

Chris McCampbell
Graphic Design

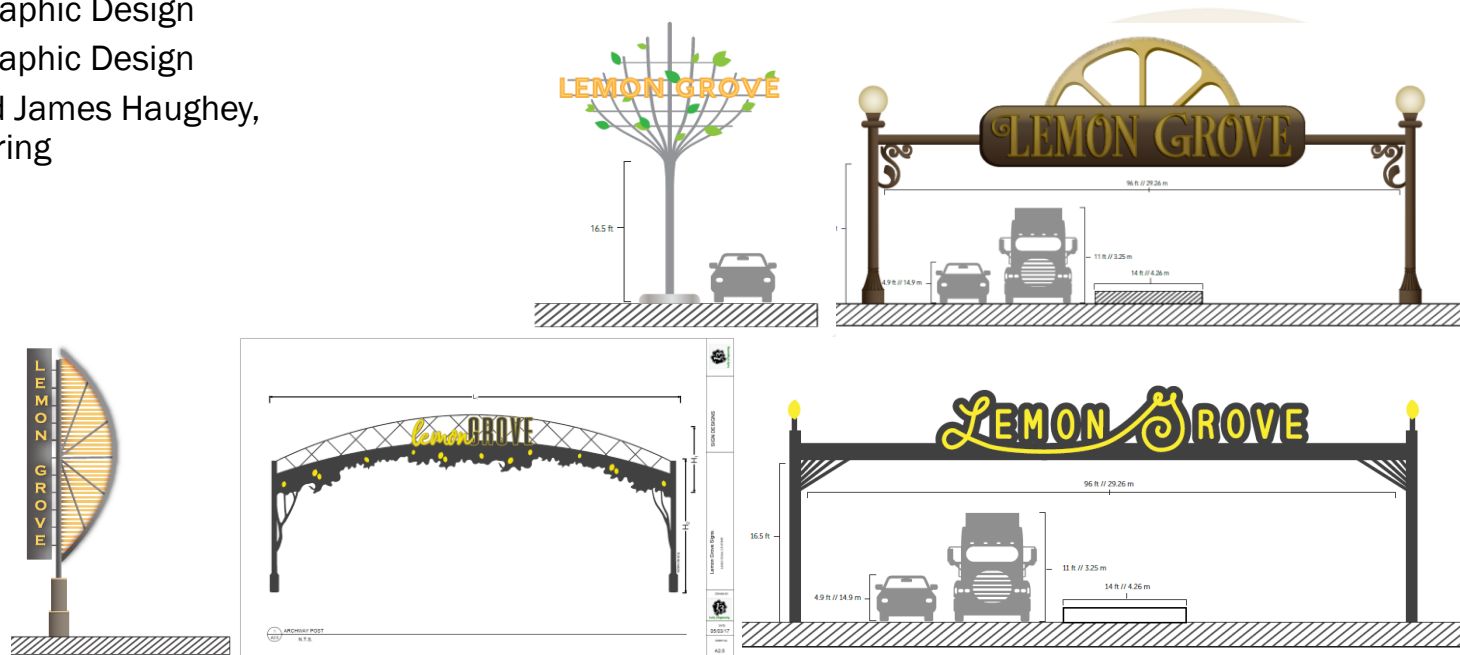

Image Development and Gateways

Patricia Cué, Graphic Design

Gary Benzel, Graphic Design

John Prince and James Haughey,
Civil Engineering



Parks and Recreation

Community Gardens

Kristen Maher, Political Science

Zohir Chowdhury, Public Health

Shawn Flanigan, Public Administration



Value Add

Climate Action Planning

Zohir Chowdhury
Public Health

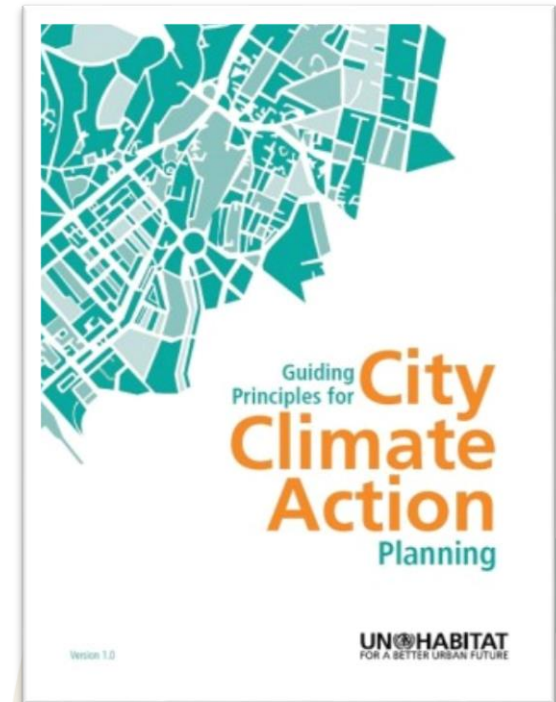

First US application of UN Habitat
Guiding Principles toolkit

Impact:



700+
STUDENTS



7 PROJECTS



27
ASSISTANT/INTERNSHIPS



19 FACULTY
MEMBERS



31
CLASSES

12
DISCIPLINES



SAN DIEGO STATE
UNIVERSITY



THE sage PROJECT

Value add

Collaboration and co-promotion of partnership, local events, and community clean-ups via social media and email blasts



Value add

Photography Project

Kiku Fukushima

Sage Project Graphic Design Intern

Scenes from Lemon Grove

City of Lemon Grove Website Photography Project



SAN DIEGO STATE
UNIVERSITY



THE sage PROJECT

Value add

Installation of mural designed by SDSU student in a Sage-sponsored course



Value add

Positive press at local, national, and international levels



The San Diego Union-Tribune

Lemon Grove may be first in US to use UN toolkit for climate plan

By Gary Warth

NOVEMBER 18, 2016, 11:45 AM | LEMON GROVE

A partnership with San Diego State University could result in Lemon Grove being the first city in the nation to use a United Nations toolkit to address climate change.



Friday, June 02, 2017

SDSU's Sage Project Creates Public Art for Lemon Grove

An SDSU environmental graphic design class beautifies the City of Lemon Grove with a public mural.

By Katie White

Thank You!

Contact:

Jessica Barlow, Director
The Sage Project
San Diego State University
+1-619-594-3807
jbarlow@sdsu.edu

sage.sdsu.edu



Envisioning a Lemon Grove Gateway

JAMES DAVISSON (PRESENTER AND REPORT WRITER)

KRYSTAL AYALA, TINA CAMERA, ALEXANDER FROST, ERIC HENSON, HECTOR SALGADO;
DR. BRUCE APPLEYARD

CP 695 COMPUTER APPLICATIONS FOR URBAN DESIGN & CP 700 URBAN DESIGN AND
LAND USE PLAN STUDIO

Site location

LOCATION WITHIN THE REGION

Figure 1.1 Location within the San Diego Region

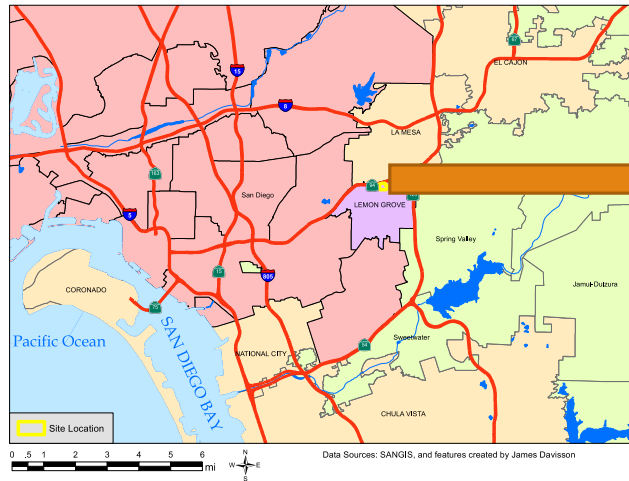

LOCATION WITHIN LEMON GROVE

Figure 1.2 Location within the City of Lemon Grove

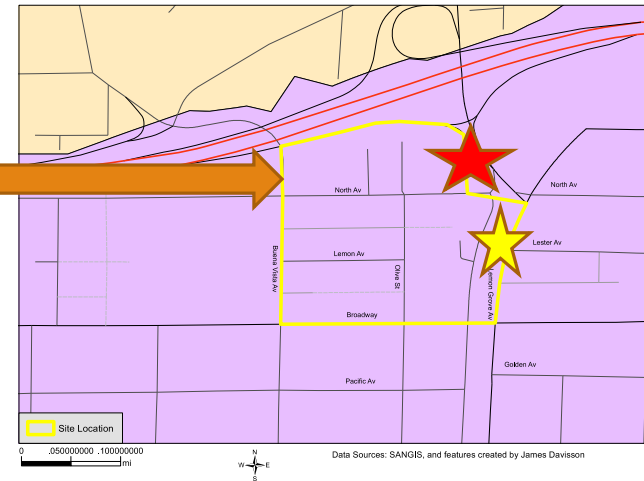

Purpose and Data

Sought to provide recommendations

Multiple alternatives were proposed

Important data from census (2015 ACS) (2014 BLS)

- Median household income
 - \$30,000
- Housing unit density
 - 3.6 HU/ac
- Jobs density
 - 7.3 jobs per acre
- Transit ridership
 - 21.5%
- Walking
 - 1.9% (within the site location)
 - 12.7% (CBG to the west)
- CalEnviroScreen 2.0
 - 71 to 75% impact for the census tracts along CA-94

Major History

- In 1905, Lemon Grove was regarded as the “Pasadena of San Diego” due to the ideal landscape.
- Roberto Alvarez vs. the Board of Trustees of Lemon Grove School District
 - 1931 became the first successful school desegregation court case in the history of the United States

Tactical Urbanism (Locations)

LOCATIONS FOR IMPLEMENTING EFFECTIVE TACTICAL URBANISM



LEMON GROVE TROLLEY DEPOT



Tactical Urbanism Examples

RESULT OF “TAKE BACK THE ALLEY” EFFORTS
IN NORTH PARK



WATER PUMP PARK GARDEN



High Commercial



Using existing zoning

Increase in economic growth for the City of Lemon Grove

Added shopping mall and warehouse space
(possible brewery)

El Limón



Proposed Land Use Changes

- Addition of mixed-use
- Wrap around parking
- Commercial opportunities
- Increased park space
- Garden space
- Outdoor eating and picnic areas

Park Elements

PLAYGROUND FACING SOUTH TOWARD
NORTH AVENUE



GARDEN FACING SOUTH TOWARD NORTH
AVENUE



Park Elements

PARK FACING NORTH TOWARD NORTH AVENUE



SEATING AREA FACING NORTH TOWARD ALLEY BETWEEN LEMON AVENUE AND NORTH AVENUE



Park Elements

SKATE PARK FACING NORTH TOWARD LEMON AVENUE



Video of El Lìmon



Thank you for your time

Questions?

Comments?

Community Gardens



ADDRESSING HOMELESSNESS IN LEMON GROVE

PREPARED FOR: LEMON GROVE CITY COUNCIL

PREPARED BY: MATTHEW A. STROUP, M.A., APR+M



RESEARCH QUESTIONS

1. What policies and institutions are in place at the county, state, and federal levels?
2. What strategies are most effective and appropriate for addressing homelessness locally?
3. What are important considerations when engaging homeless residents?
4. Should addressing homelessness be a top priority for the Mayor and City Council?



WHERE WE ARE

*“I don’t know that any city can
say that they’re winning.”*

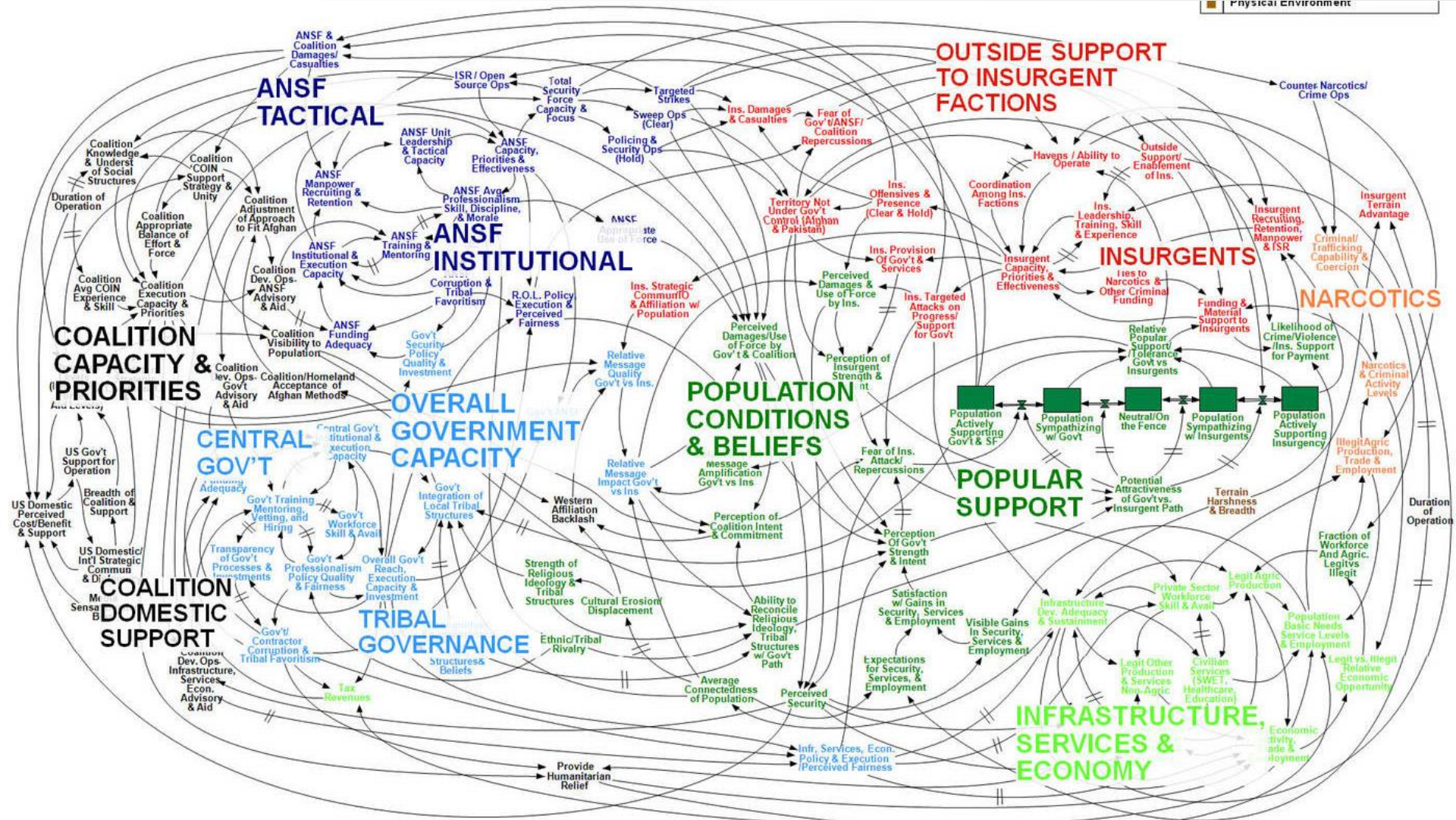

RECOMMENDATIONS

- Make homelessness a top priority in the Lemon Grove City Council's Agenda.
- Join and actively participate in the Regional Task Force on the Homeless.



QUESTIONS?

Lemon Grove Climate Action Planning

Adaptation and Mitigation Strategies for Climate Change in Lemon Grove, CA

Introduction

- Lemon Grove has collaborated with the Sage Project and San Diego State University in order to brainstorm possibilities for climate change mitigation and adaptation.
- These ideas have been developed specifically to reduce GHG emissions across many sectors:
 - Energy
 - Transportation
 - Land use



Lemon Grove GHG Emission Inventory

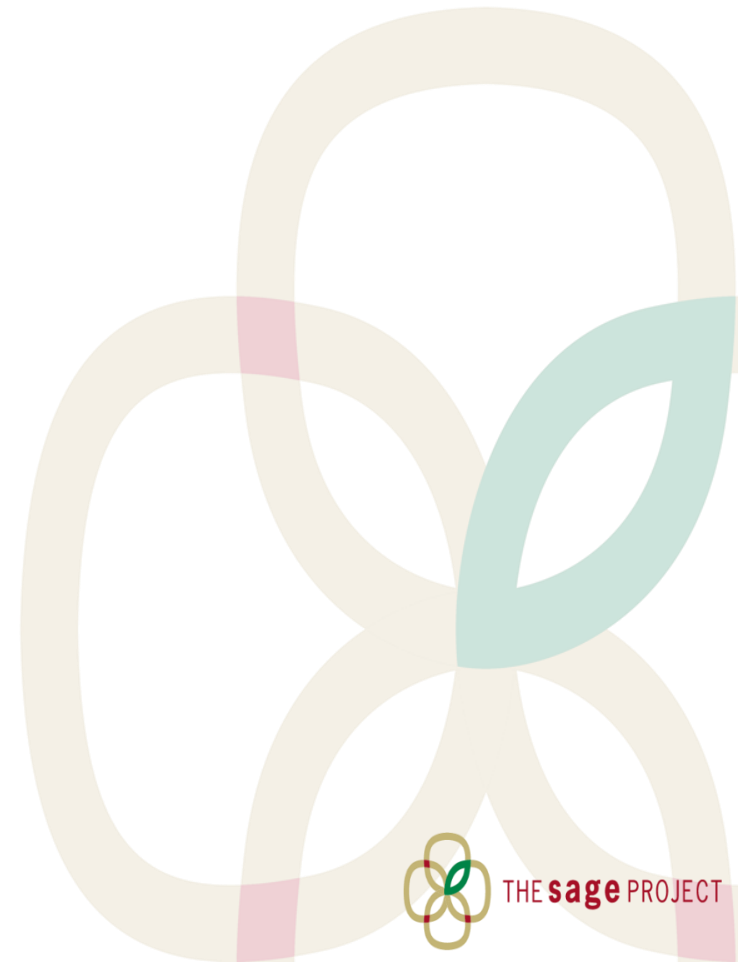
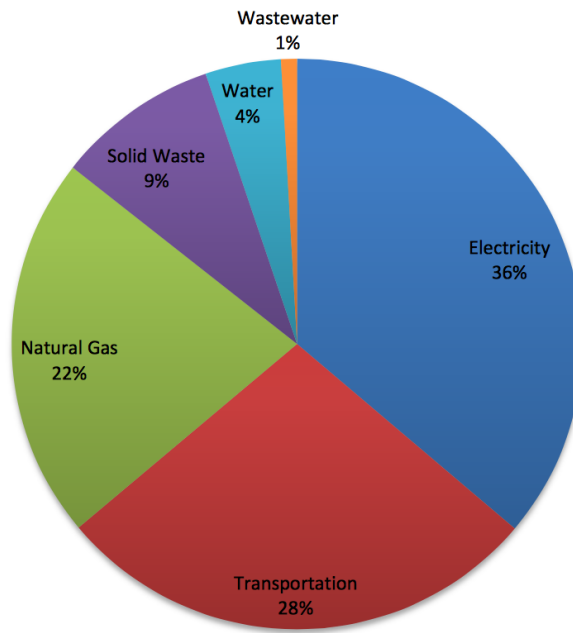

Objectives

- Formulate adaptation and mitigation strategies to combat climate change within the City of Lemon Grove
- Student engagement with city officials to provide hands-on experience in city planning at a small government level
- Utilization of the United Nations Habitat Toolkit to help the City formulate a strong Climate Action Plan (CAP)

United Nations Guiding Principles for the City Climate Action Planning “Toolkit”

- Resource for cities worldwide to develop a new CAP or for evaluating existing CAPs
- Eight guiding principles:
 - Ambitious
 - Inclusive
 - Fair
 - Comprehensive
 - Integrated
 - Actionable
 - Evidence-based
 - Transparent and Verifiable



EARTH'S CLIMATE CHANGE

WHAT IS GLOBAL WARMING?

Earth's average temperature is rising. This increase in temperature melts ice over the land resulting in sea level rise. Humans have contributed to global warming through increase in carbon dioxide and other greenhouse gases in the atmosphere.



WHAT IS CLIMATE ACTION?

A strategic plan to decrease the amount of greenhouse gases emitted by a city over a period of time.

HOW CAN YOU GET INVOLVED?

- ☐ Walk, bike, carpool or use public transportation
- ☐ Recycle and compost
- ☐ Use low-water landscaping methods
- ☐ Drive alternative fuel vehicles
- ☐ Install solar or wind power devices to supply your house with electricity
- ☐ Incorporate high efficiency appliances in your home



EL CAMBIO CLIMÁTICO

¿QUÉ ES EL CALENTAMIENTO GLOBAL?

La temperatura de la tierra está aumentando. Este aumento en la temperatura derrite el hielo sobre la tierra y ocasiona que el nivel del agua del mar se eleve. Los humanos hemos contribuido al calentamiento global mediante el incremento de emisiones a la atmósfera de dióxido de carbono y de otros gases de efecto invernadero.



¿QUÉ ES LA ACCIÓN CLIMÁTICA?

Es un plan estratégico para disminuir en un tiempo determinado la cantidad de gases de efecto invernadero emitidos en la ciudad.

¿CÓMO PUEDE USTED AYUDAR PARA PREVENIR EL CAMBIO CLIMÁTICO?

- ☐ Camine, use la bicicleta, comparta el automóvil o utilice el transporte público cuando le sea posible
- ☐ Recicle y composte
- ☐ Utilice métodos de reducción de gasto de agua
- ☐ Opte por vehículos que utilicen combustible alternativo
- ☐ Utilice electrodomésticos de alto rendimiento en su hogar



Climate Change Survey English Version

Surveyor: _____

Survey Number: _____

Please take a few minutes to fill out this survey. SDSU and the Sage Project appreciate your feedback and your answers will be kept confidential. Thank you for your participation!

1. How important is the issue of climate change to you?

☐ Very important ☐ Important ☐ Somewhat important ☐ Not important ☐ Don't know

2. Do you think climate change is an issue that is affecting you or will affect you personally?

☐ Very likely ☐ Likely ☐ Somewhat likely ☐ Not likely ☐ Very unlikely ☐ Don't know

3. Rank from 1 to 5 the following modes of transportation by the ones you use most frequently to get around (1 being the least)

Driving **alone** motorized vehicles (car, motorcycle)

☐

Carpooling

☐

Public Transportation

☐

Walk or Ride non-motorized vehicles (bike, skateboard)

☐

4. Do you see yourself participating in climate change prevention strategies? (Ex. Improving energy efficiency in your home, recycling and composting, low-water landscaping methods)

☐ Very likely ☐ Likely ☐ Somewhat likely ☐ Not likely ☐ Very unlikely ☐ Don't know

5. What would you need in order to use the prevention strategies mentioned in the above question? Check all that apply

- ☐ Incentives and rebates
- ☐ Community support
- ☐ Personal motivation
- ☐ Educational information

Mitigation and Adaptation Strategies: Biking infrastructure improvement

- Reconstructing bike lanes (Class IV)
- Creating bike paths and sidewalks that connect the cities streets
- Bicycle rental kiosks
- Incentives for residents who bike or choose alternative transportation



Mitigation and Adaptation Strategies: Solar

FOUR

INSTALL SOLAR PANELS

- Solar panels can be installed on school rooftops and used as shade in parking areas.
- Generate power via the capture of electrons in photovoltaic cells (Union of Concerned Scientists, 2015).
- Cost-effective means of generating electricity: Among schools currently equipped with solar panels, average savings of \$21K per year and median production of 89kW, equal to ~18 residential homes (The Solar Foundation, 2014).

Solar Panels Installed on School



<http://www.energysavingcorporation.com/wp-content/uploads/2015/06/Solar-Panels-Installed-over-Schools-or-Hospitals1.jpg>

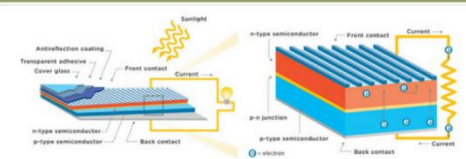

Solar cells are composed of two layers of semiconductor material with opposite charges. Sunlight hitting the surface of a cell knocks electrons loose, which then travel through a circuit from one layer to the other, providing a flow of electricity.

© JAMISON THORNTON/SHUTTERSTOCK

<http://www.ucsusa.org/sites/default/files/imagess/2015/12/energy-graphic-how-pv-solar-panel-works.jpg>

Mitigation and Adaptation Strategies: Green Space Expansion

- Converting empty land spaces into parks
- Planting trees that are drought resistant
- Albizia Julibrissin trees







Resources

- Grants
- Bonds
- Charitable foundations
- Leasing agreements
- Power purchase agreements
- Rebate programs



Thank you!

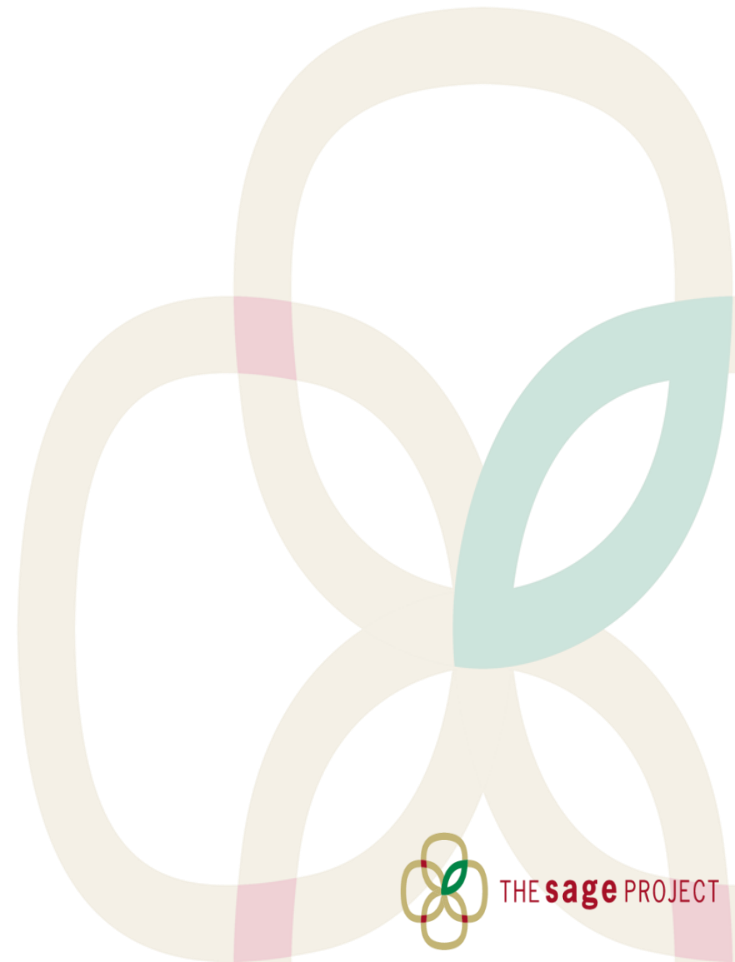



THE **sage** PROJECT

Community Engagement for Sustainable Cities

2016-17 Partnership with Lemon Grove



SAN DIEGO STATE
UNIVERSITY